

Great Lakes Poodle Club of Chicago

(Licensed by the American Kennel Club)

Wednesday, May 24, 2023



Specialty and All Breed Rally and Obedience Trials

Poodles have preferred entry

All other breeds (including All-American Dogs) accepted on first-come first-served basis after Poodle entries

Rally Trial

Limited to 75 entries
(AKC Event # 2023011702)

Obedience Trial

Limited to 8 hours judging
(AKC Event #2023011703)

Show Hours 7:00 a.m. – 5:00 p.m.

Trials start 8:30 a.m. to run simultaneously

To be held at: Francis Field Youth Building - Indoors
801 E. Francis Road
New Lenox, IL 60451

Entries open Wednesday, February 1, 2023

Entries close Wednesday, May 10, 2023

This show is held under The American Kennel Club Rules

Certification: Permission has been granted by the American Kennel Club for the holding of this event under American Kennel Club Rules and Regulations.

Gina M. Dinardo, Executive Secretary



GREAT LAKES POODLE CLUB OF CHICAGO OFFICERS

President Marilyn Page
Vice President Kathy Watson
Treasurer Larry Page
Corresponding Secretary..... Charlene Newkirk
Recording Secretary Carol Cargle
Directors..... Robert "Butch" Singson, Kelly Haas,
..... Drusilla Flowers, Carlos Santos

EVENT COMMITTEE

Trial Chairperson Kathy Watson
26014 S. Castle Gate Dr., Monee, IL 60449
kmuscolinowatson@outlook.com (708) 269-2710

SHOW COMMITTEE

All members of GLPC present

EVENT SECRETARY

Dianne Allen
c/o Robert Olson
817 Ogden Ave #4439, Lisle, IL 60532
(815) 242-5483 secretary@livetrial.net

Veterinarian On Call

Animal Emergency of Mokena
19110 S. 88th Avenue, Mokena, IL 60448
708-326-4800

Directions to Animal Emergency of Mokena from the show site:

Turn left from the building onto eastbound Francis Rd.
Drive 2.9 miles to Front St. Turn left.
Drive 0.4 miles to Wolf Road. Turn left.
Drive 0.8 miles to 191st St. Turn right.
Drive 3.0 miles to 88th Ave. Turn right.
The offices will be almost immediately on your right.

CLASSES OFFERED

Obedience – Regular Classes

Novice A, Novice B, Open A, Open B, Utility A, Utility B, UDX

Obedience – Preferred Classes

Preferred Novice, Preferred Open, Preferred Utility, Preferred UDX

Obedience – Optional Titling Classes

Beginner Novice A, Beginner Novice B,
Graduate Novice, Graduate Open
Versatility

Rally – Regular Classes

Novice A, Novice B, Intermediate, Advanced A, Advanced B,
Excellent A, Excellent B, Master, RAE, RACH
Rally Ring Size: 36' x 50'

Rally – Non-Regular Classes

Novice Pairs Novice Teams

Obedience and rally entries must include dog's jump height if applicable.

Rally classes are limited to 75 entries.

Obedience classes are limited to 8 hours of judging.

JUDGES AND ASSIGNMENTS

(p) denotes a provisional judge

Dr. Sandy Gould #92112..... 501 Terry Dr, Joliet, IL 60435
All Rally Classes

Fred Buroff #5277.....2405 Essington Rd Suite B-91, Joliet, IL 60435
All Obedience Classes

Transfers

Transfers after the closing date will be accepted at these trials.

Jump Height Order

Obedience and rally classes with jumps will be run small to tall starting with 4".

Every effort will be made to accommodate handlers with multiple dogs in the same class.

ENTRY FEES: *Fees are for each dog, for each event.*

First obedience class entry\$28.00

Each additional obedience entry\$22.00

First rally class entry\$28.00

Each additional rally entry\$22.00

Rally Team entry\$28.00 per team

Rally Pairs entry\$28.00 per pair

Obedience entry fees include \$0.50 AKC Recording Fee and \$3.00 Service Fee.

Rally entry fees include a Recording Fee of \$3.50 for the first Rally entry and \$3.00 for each additional Rally entry each day.

A waitlist will be maintained in accordance with the Obedience Regulations Ch. 1, Sec. 27 in order to fill openings created by withdrawals before closing.

Each event requires a first-entry fee of \$28.

Rally and Obedience are different events. Each requires a first-entry fee of \$28.

Make checks payable to Great Lakes Poodle Club.

Entry fees must be paid in US funds.

Mail entries and fees to: Robert Olson – GLPC
817 Ogden Ave #4439
Lisle, IL 60532

Be sure to include the #4439 in the address. Omitting it will result in the USPS delaying or returning your entry.

Hand delivery address 22W462 Sycamore Dr, Glen Ellyn, IL in the dropbox next to the front door.

All entries must be submitted on official AKC entry forms, one dog per entry form. Photocopies of entry forms without the AKC Agreement are not acceptable. Unsigned, incomplete, or illegible entries are not acceptable.

If you would like confirmation that your entry was received before the trial has closed, please include your email address or enclose a self-addressed stamped postcard.

Entries cannot be changed once the trial has closed.

Please check your entries!

Dogs Eligible to Enter

This trial is open to all dogs six (6) months of age or older that are registered with the American Kennel Club or that have AKC Limited Registration, Purebred Alternative Listing/Indefinite Listing Privileges (PAL/ILP) or an AKC Canine Partners listing number or are approved Foundation Stock Service (FSS) breeds.

Dogs with a PAL/ILP number or an AKC Canine Partners listing number must be spayed or neutered in order to compete. Dogs should be physically sound. Dogs that are blind or deaf, bitches in season, aggressive dogs, or dogs suffering from any deformity, injury, or illness which may affect a dog's physical or mental performance are not eligible to compete. No dog shall compete if it is taped or bandaged in any way or has anything attached to it for medical purposes. Refer to Chapter 2 of the Rules Applying to Registration and Discipline for the listing of registerable breeds that may participate.

Wherever the word "dog" is used in these regulations, it includes both sexes.

Notice to Exhibitors

The safety of the dogs is our primary concern. By entering these trials, exhibitors acknowledge that they are familiar with the rules and regulations of this sport and that their dogs are familiar with and able to perform all exercises safely.

Entry fees will not be refunded if the trials cannot be opened or completed by reason of riots, civil disturbance, fire, an act of God, public emergency, an act of a public enemy, or any other cause beyond the control of the organizing committee.

Entry fees will not be refunded in the event that a dog is absent, disqualified, excused, or barred from competition by action of the Event Committee.

Since **bitches in season** are not allowed to compete in AKC Obedience or Rally Trials, the club will refund all but \$10.00 of the entry fee per day for bitches unable to compete for that reason. The Trial Secretary must receive written notification from a veterinarian of such a claim for refund by letter hand-delivered, emailed, or postmarked before the trial commences.

No refunds other than bitches in season will be offered.

It is expressly understood that exhibitors alone are responsible for the behavior of their dogs and/or children. Any exhibitor whose dogs and/or children create unnecessary disturbances or repeatedly engage in unsafe or disruptive behavior may, at the discretion of the Event Committee, be asked to leave the trial site. In such case, no refund of any fees paid will be made.

Exhibitors are responsible for being ready for judging when called to the ring. The judge need not wait for any dog holding up a class. The Show-Giving Club and Show Secretary have no obligation or responsibility for providing service through a public address system, or stewards or

runners for the purpose of locating dogs that are not brought into the ring when required.

Entries must be made on Official AKC entry forms or copies and must include the signed Agreement and Rules. Junior Handlers must complete back of form.

All owners of mixed breed dogs must first obtain an AKC Canine Partners listing number before they may enter an AKC event. The dog's breed name should be entered as "All American Dog". The dog's listing number must be entered on the entry form and "AKC No." checked.

Exhibitors should follow their veterinarians' recommendation to assure their dogs are free of internal and external parasites and any communicable diseases and have appropriate vaccinations.

Owners are responsible for errors in making out entry forms, whoever may have made such errors. No entry will be refunded in the event of such errors or cancellation of entries after the published closing date. Errors in entries made by the exhibitor cannot be corrected after the closing date.

Returned checks do not constitute a valid entry fee. There is a \$25 returned check fee.

All dogs must be on leash or crated at all times except when in the ring. Warm-up must be done on lead.

Dogs under 6 months of age are not permitted on the show grounds of AKC events.

Exhibitors are responsible for cleaning up after their dog(s) at the show site and at all hotels, motels, and campgrounds where they are staying while competing in these trials.

Per AKC Obedience Regulations Chapter 2, Section 17:

All dogs in the obedience ring must wear a properly fitted collar approved by the judge. No dog may enter the ring, either for judging or for awards, with unacceptable equipment. No special training collars, such as electronic collars or prong collars, will be permitted. Nothing may be hanging from the dog's collar.

Pre-Order Catalogs. Catalogs may be pre-ordered for \$3.00 per catalog. Check the catalog box on the entry form and include \$3.00 per with your entry fees. A limited number of catalogs will be available for purchase at the trial for \$4.00 per catalog.

Trial hours are 7:00 a.m. – 5:00 p.m. CST.

No smoking is allowed in the building.

Crating. Indoor crating available.

Obedience Ribbon Prizes

Highest Scoring Dog in Regular Classes
..... Blue & Gold Rosette
Highest Scoring Dog in Preferred Classes
..... Blue & Gold Rosette
Highest Combined Score in Open B and Utility
..... Blue & Green Rosette
First Prize Blue Ribbon
Second Prize Red Ribbon
Third Prize Yellow Ribbon
Fourth Prize White Ribbon
New Title Ribbon
Qualifying Score Green Ribbon

Obedience Awards

Highest Scoring Dog In Regular Classes \$25.00
Highest Combined Score in Open B and Utility \$25.00

Rally Ribbon Prizes

Highest Combined Score in Advanced B and Excellent B...
..... Blue & Green Rosette
Highest Combined Triple Qualifying (HTQ) score in
Advanced B, Excellent B and Master
..... Blue & Red Rosette

Regular Class Placements:

First Prize Blue Ribbon
Second Prize Red Ribbon
Third Prize Yellow Ribbon
Fourth Prize White Ribbon

Nonregular Class Placements:

First Prize Rose Ribbon
Second Prize Brown Ribbon
Third Prize Light Green Ribbon
Fourth Prize Gray Ribbon

New Title Ribbon
Qualifying Score Green Ribbon

Rally Awards

Highest Combined Score in Advanced B and Excellent B
..... \$25.00
Highest Combined Triple Qualifying (HTQ) score in
Advanced B, Excellent B and Master \$25.00



Great Lakes Poodle Club of Chicago Obedience & Rally Trial
Wednesday May 24, 2023 OFFICIAL AKC ENTRY FORM

Entry fees \$28 for first entry per dog per trial, \$22 each additional entry per dog per trial

Rally Obedience

Checks payable to **Great Lakes Poodle Club** Catalog (\$3)

Mail to **Robert Olson – GLPC,**
817 Ogden Ave #4439, Lisle, IL 60532

I have enclosed \$ _____ for entry fees

IMPORTANT Read *Instructions* on reverse side carefully before filling out. Numbers in the boxes indicate sections of the instructions relevant to the information needed in that box (PLEASE PRINT). Next, be sure to **read the Agreement and sign on the reverse.**
No form will be processed without your signature!

Breed ¹	Variety ¹	Sex
Obedience Class ^{2,3}	Jump Height	Additional Obedience Class ^{2,3}
Additional Obedience Class ^{2,3}	Rally Class / Jump Height	Additional Rally Class ^{2,3}
Name of Junior Handler (If Any)		Junior Handler Number
Full Name of Dog		

<input type="checkbox"/> AKC No. ⁴ Enter number here	<input type="checkbox"/> Foreign Reg No	Place of Birth (Enter country below) <i>Do not print the country in catalog</i>	Date of Birth
Breeder			
Sire			
Dam			
Actual Owner(s) (Please Print)			
Owner's Address			
City	State/Prov	Zip/Postal Code	Country (if not USA)
Telephone #	Are you a new exhibitor? <input type="checkbox"/> Yes <input type="checkbox"/> No		
Email Address (an acknowledgement or receipt of entry may be sent to this email address)			
Name of Agent/Handler at the Show (if any)			

*** Be sure to read the Agreement and sign on the reverse. No form will be processed without your signature! ***

INSTRUCTIONS

- (Variety) if you are entering a dog of breed in which there are varieties for show purposes, please designate the particular variety you are entering, i.e., Cocker Spaniel (solid color black, ASCOB, parti-color), Beagles (not exceeding 13 in., over 13 in. but not exceeding 15 in.), Dachshunds (longhaired, smooth, wirehaired), Collies (rough, smooth), Bull Terriers (colored, white), Manchester Terriers (standard, toy), Chihuahuas (smooth coat, long coat), English Toy Spaniels (King Charles and Ruby, Blenheim and Prince Charles), Poodles (toy, miniature, standard).
- (Event Class) Consult the classification in this premium list. If the event class in which you are entering your dog is divided, then, in addition to designating the class, specify the particular division of the class in which you are entering your dog, i.e. A or B division.
- A dog must be entered in the name of the person who actually owned it at the time entries for an event closed. If a registered dog has been acquired by a new owner it must be entered in the name of its new owner in any event for which entries closed after the date of acquirement, regardless of whether the new owner has received the registration certificate indicating that the dog is recorded in his/her name. State on entry form whether transfer application has been mailed to the AKC. (For complete rules, refer to Chapter 11, Section 3.)
- Dogs listed in the **AKC Canine PartnersSM** Program may be eligible to enter all-breed AKC Obedience trials at the club's option. These dogs should be listed as All American Dog and must include their AKC Number on the entry form and check the AKC No. box. Sire and Dam information shall remain blank for mixed breed entrants.

AKC Rules, Regulations, Policies and Guidelines are available on the American Kennel Club website: www.akc.org

AGREEMENT

I certify that I am the actual owner of the dog, or that I am the duly authorized agent of the actual owner whose name I have entered above. In consideration of the acceptance of this entry, I (we) agree to abide by the rules and regulations of The American Kennel Club in effect at the time of this event, and any additional rules and regulations appearing in the premium list of this event and entry form and any decision made in accord with them. I (we) agree that the club holding this event has the right to refuse this entry for cause which the club shall deem sufficient. I (we) certify and represent that the dog entered is not a hazard to persons or other dogs. In consideration of the acceptance of this entry and of the holding of this event and of the opportunity to have the dog judged and to win prizes, ribbons, or trophies, I (we) agree to hold the AKC, the event-giving club, their members, directors, governors, officers, agents, superintendents or event secretary and the owner and/or lessor of the premises and any provider of services that are necessary to hold this event and any employees or volunteers of the aforementioned parties, and any AKC approved judge, judging at this event, harmless from any claim for loss or injury which may be alleged to have been caused directly or indirectly to any person or thing by the act of this dog while in or about the event premises or grounds or near any entrance thereto, and I (we) personally assume all responsibility and liability for any such claim; and I (we) further agree to hold the aforementioned parties harmless from any claim for loss, injury or damage to this dog. Additionally, I (we) hereby assume the sole responsibility for and agree to indemnify, defend and save the aforementioned parties harmless from any and all loss and expense (including legal fees) by reason of the liability imposed by law upon any of the aforementioned parties for damage because of bodily injuries, including death at any time resulting therefrom, sustained by any person or persons, including myself (ourselves), or on account of damage to property, arising out of or in consequence of my (our) participation in this event, however such, injuries, death or property damage may be caused, and whether or not the same may have been caused or may be alleged to have been caused by the negligence of the aforementioned parties or any of their employees, agents, or any other person. I (we) agree that the determination of whether the injury is serious shall be made by the event veterinarian and is binding on me (us). **I (WE) AGREE THAT ANY CAUSE OF ACTION, CONTROVERSY OR CLAIM ARISING OUT OF OR RELATED TO THE ENTRY, EXHIBITION OR ATTENDANCE AT THE EVENT BETWEEN THE AKC AND THE EVENT-GIVING CLUB (UNLESS OTHERWISE STATED IN THIS PREMIUM LIST) AND MYSELF (OURSELVES) OR AS TO THE CONSTRUCTION, INTERPRETATION AND EFFECT OF THIS AGREEMENT SHALL BE SETTLED BY ARBITRATION PURSUANT TO THE APPLICABLE RULES OF THE AMERICAN ARBITRATION ASSOCIATION. HOWEVER, PRIOR TO ARBITRATION ALL APPLICABLE AKC BYLAWS, RULES, REGULATIONS AND PROCEDURES MUST FIRST BE FOLLOWED AS SET FORTH IN THE AKC CHARTER AND BYLAWS, RULES, REGULATIONS, PUBLISHED POLICIES AND GUIDELINES.**

■ Signature of owner or his agent
duly authorized to make this entry:

Telephone	Email
-----------	-------

ACCOMODATIONS

Following are hotels that accept well-mannered, housebroken dogs. Managers request that grooming be restricted to show grounds. Owners are responsible for cleaning up after their dogs.

LaQuinta Inn & Suites Chicago Tinley Park

7255 W. 183rd, Tinley Park, IL 60477 708-633-1200

Motel Super 8 Mokena / Frankfort / I-80

9485 W. 191st St, I-80 at Exit 145A, Mokena IL 60448-8308
708-479-7808

**Please notify the motel of your choice
that you have pets!**

DIRECTIONS TO TRIAL SITE

From I-80

Exit Route 30 (Maple Street) East. To Cedar Road stop light turn Left. To Francis Road turn Right. The 4H field will be on your left.

From I-355

Exit on Route 6. Go East on Route 6, to Cedar stoplight turn Right. To Francis Road turn Left. The 4H field will be on your left.

From Route 50 or 45. Go to Laraway Road or Route 30. Turn West to SchoolHouse Road, turn Right. (just West of Wolf Road - Stop Sign if coming off of Laraway, Stop Light if coming off of Route 30; Deadend on Francis Road - turn Left. The 4H field will be on your right about a mile down.

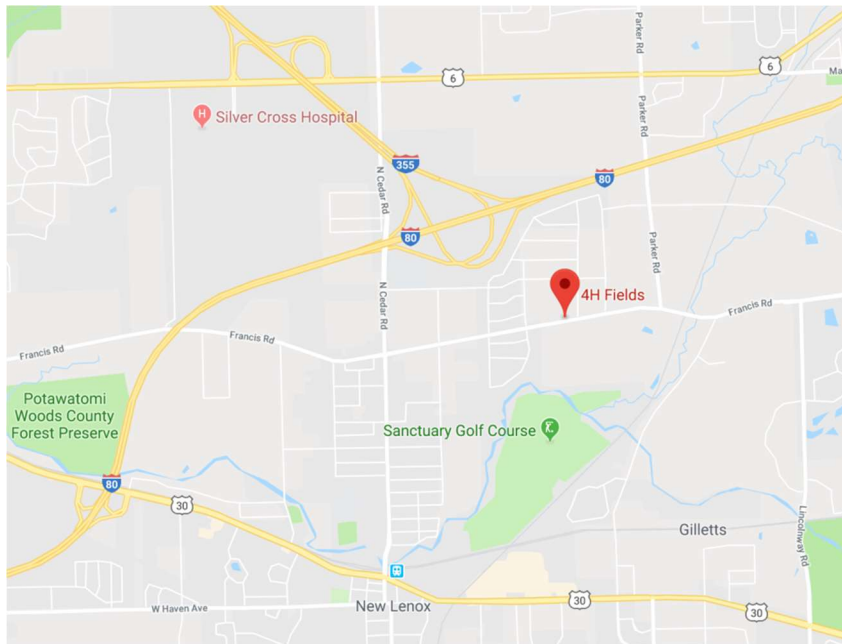

AKC Code of Sportsmanship

PREFACE: The sport of purebred dog competitive events dates prior to 1884, the year of AKC's birth. Shared values of those involved in the sport include principles of sportsmanship. They are practiced in all sectors of our sport: conformation, performance and companion. Many believe that these principles of sportsmanship are the prime reason why our sport has thrived for over one hundred years. With the belief that it is useful to periodically articulate the fundamentals of our sport, this code is presented.

- Sportsmen respect the history, traditions and integrity of the sport of purebred dogs.
- Sportsmen commit themselves to values of fair play, honesty, courtesy, and vigorous competition, as well as winning and losing with grace.
- Sportsmen refuse to compromise their commitment and obligation to the sport of purebred dogs by injecting personal advantage or consideration into their decisions or behavior.
- The sportsman judge judges only on the merits of the dogs and considers no other factors.
- The sportsman judge or exhibitor accepts constructive criticism.
- The sportsman exhibitor declines to enter or exhibit under a judge where it might reasonably appear that the judge's placements could be based on something other than the merits of the dogs.
- The sportsman exhibitor refuses to compromise the impartiality of a judge.
- The sportsman respects the AKC bylaws, rules, regulations and policies governing the sport of purebred dogs.
- Sportsmen find that vigorous competition and civility are not inconsistent and are able to appreciate the merit of their competition and the effort of competitors.
- Sportsmen welcome, encourage and support newcomers to the sport.
- Sportsmen will deal fairly with all those who trade with them.
- Sportsmen are willing to share honest and open appraisals of both the strengths and weaknesses of their breeding stock.
- Sportsmen spurn any opportunity to take personal advantage of positions offered or bestowed upon them.
- Sportsmen always consider as paramount the welfare of their dog.
- Sportsmen refuse to embarrass the sport, the American Kennel Club, or themselves while taking part in the sport.